

Steps for easy placement

- Intestinal Tube placement**
 - FR 8: Placement through the working channel (2.8 mm) of the endoscope
 - Exact placement into the jejunum without a guidewire is possible under visual control
 - Biocompatible, made of Polyurethane according to ISO 10993
- Re-routing of the Intestinal Tube with the re-routing catheter**
 - Easy access from oral to transnasal route
- Gastric Tube placement**
 - Larger lumen Tube for gastric decompression and/or medication
- Easy adaptor connection and variable in length**
 - Adaptation of the proximal length of the Intestinal Tube according the patients needs
 - Quick connection of the Tubes via the proven technique of the Freka® Click adapter, ENFit

Ordering information

	Size in ml	Packaging	Art.No.
Feeding Tubes, ENFit			
Freka® EasyIn, ENFit Double lumen Intestinal Feeding and Decompression Tube		1 x 1	7981833
Freka® Endolumina, ENFit Single lumen Intestinal Feeding Tube		1 x 1	7981832
Accessories			
Enteral Freka® Plaster for Tube fixation		1 x 50	7981907
Enteral Dispensing Systems, ENFit			
	10 ml	10	9000784XS
	10 ml	30	9000784S
	10 ml	100	9000784
	20 ml	10	9000785XS
	20 ml	30	9000785S
Freka® Connect, ENFit/ProNeo	20 ml	100	9000785
	60 ml	10	9000786XS
	60 ml	30	9000786S
	60 ml	50	9000786
	100 ml	10	9000787XS
	100 ml	30	9000787

Freka® EasyIn, ENFit



Freka® EasyIn, ENFit

Double lumen Feeding Tube for

- Early intestinal feeding and gastric decompression in ICU-patients
- Easy placement through the endoscope
- Safe enteral connector ENFit, according to the new international safety standard ISO 80369-3
- Luer-free IV-incompatible connection system



Intestinal access



Gastric access



Gastric Tube/
Intestinal Tube

Variable in Tube length



Steps for easy placement

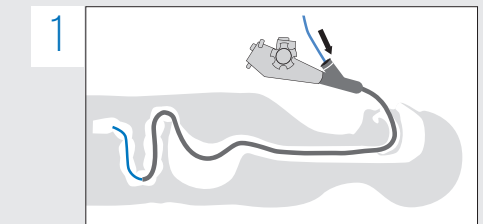

- Advance the endoscope as far as possible into the intestine
- Carefully push the Intestinal Tube through the working channel beyond the ligament of Treitz'
- Withdraw the endoscope whilst leaving the Intestinal Tube in the position
- Check the position by X-ray

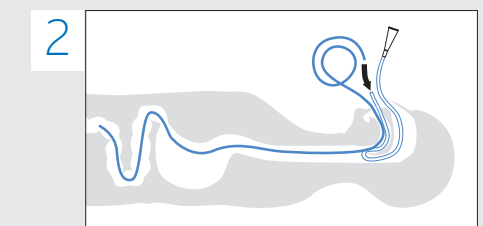

- Re-routing of the Intestinal Tube from oral to transnasal

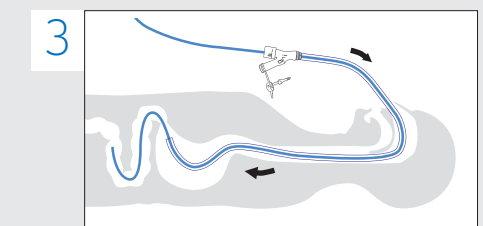

- Advance the Gastric Tube over the Intestinal Tube until it passes into the stomach as determined by a premeasured distance

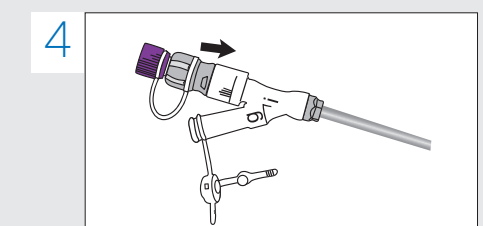

- Cut the Intestinal Tube and connect the click connector with ENFit connector